

HTW-100



TORQUE MONSTER

MODEL: HTW-100

Machine Specifications:

Machine dimensions	HTW100-30: 360" * 37.5" * 37" HTW100-40: 480" * 37.5" * 37"
Table material	HR Steel C channel A36/44W- SQ beam 350W H.S.S
Torque	95,000 ft.lb
Continues working pressure of the motor and cylinders	3000 PSI

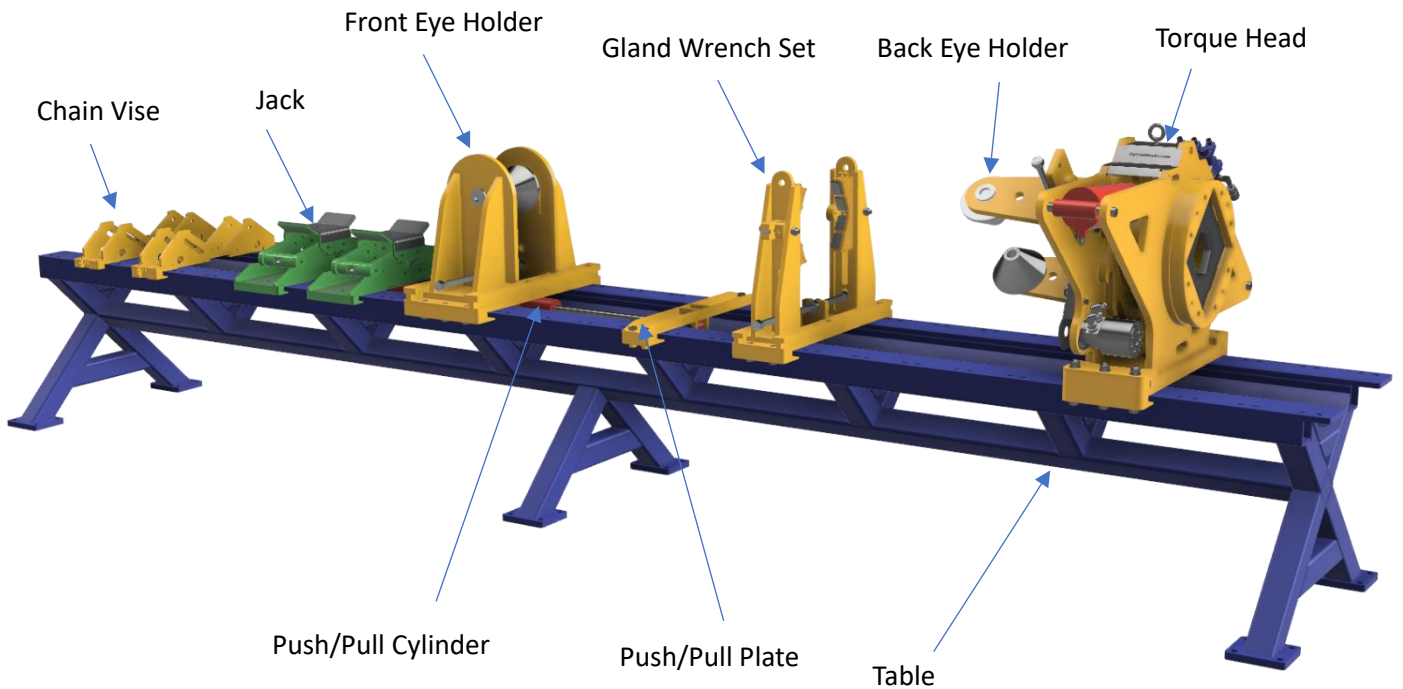

NBW-100

HTW100- Torque Head

QTY: 1

The HTW100 is designed to disassemble and/or tighten all kinds of piston nuts and cylinder glands.

- Built-in hydraulic-assisted nut runner.
- 95,000 ft.lb build up torque capacity.
- Swivel base.
- Two 5" *8" counter acting cylinders generate cracking torque.
- A fast-turning 400cc/rev motor taking action to open the nut.
- Remote or wired handheld control.
- Control unit.
- Lifting eye.



NBW-110

Front Eye Holder

QTY: 1

- The attachment holds the front eye of the cylinder as the nut is removed.
- The holder is adjustable up to 30".
- Contains a clevis for the front eye of the push/pull cylinder.

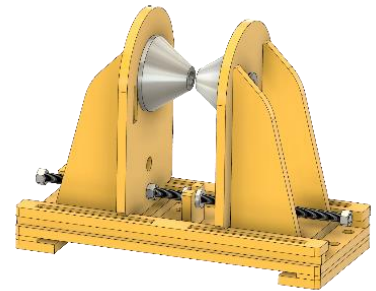

NBW-120

Gland Wrench Mechanism

QTY: 1

- The 2-in-1 gland wrench set is an attachment designed as a pipe wrench and spanner wrench.
- The pipe wrench's jaw teeth grip by digging into the material of the cylinder.
- This provides a secure 4-point grip to ensure the end caps do not rotate.
- The pipe wrench accommodates glands up to 14".
- The front and side spanner wrench grip the holes on the face or circumference of the end caps of the cylinder.
- Pins are adjusted to match the holes in the end cap.
- The spanner accommodates glands up to 20".

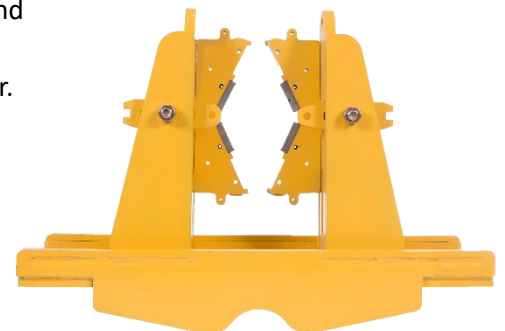

NBW-130

Wrench Set including 9 hex plates & one hex plate with socket

QTY:10

- Hex plates are nut sockets that lock into the hex plate holder and make it easy to remove and install nuts.
- Plates are available in 9 sizes, ranging from 80mm to 220mm.
- They come in 13"x13"x1" thick plates.
- A 1.5" socket drive plate is also available.
- Custom Hex Plates are available on demand.



NBW-150

Back Eye Holder

QTY: 1

- This attachment is installed onto the rotating Torque Head through fastening bolts.
- With the use of a pin bolt, the back eye of the cylinder is secured to the Torque Head.
- With the cylinder in a fixed position at the Gland Wrench Set.
- The Back Eye Holder rotates with the Torque Head to loosen the gland.
- The Back Eye Holder accommodates cylinders with the back eye up to 30".

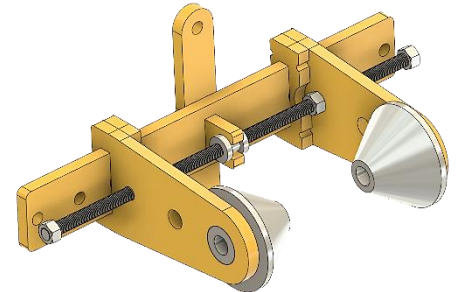

NBW-150-1

Back Tube Holder

QTY: 1

- This attachment is **optional** and is an addition to the Back eye holder.
- They will be replaced with two slides of the back eye holder.
- The attachment holds the back of the tube when there is no back eye.
- The Back tube Holder rotates with the Torque Head to loosen the gland while gland is fixed on the gland wrench set.
- This tool can be used to take off the nuts if there is no suitable socket available. In this case the front eye will be held by the front eye holder.

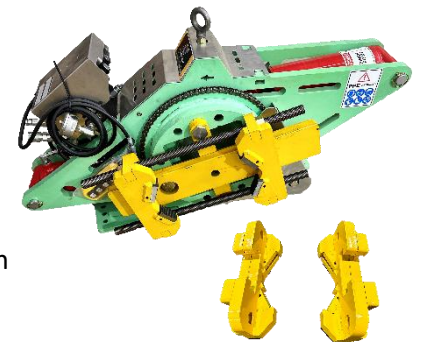

NBW-160

Scissor Jacks

QTY: 2

- The easy-to-slide lifting jacks consist of aluminum pads that help align the rod or tube before torque is applied.
- Two 5-ton lifting jack comes standard with the Torque Monster System.



NBW-170

Oil Tray

QTY: 1

- An oil tray located underneath the entire table and provides complete coverage for oil collection.

NBW-180

Table

QTY: 1

- The standard table is 30 feet long.
- It is available in 30, and 40-foot lengths, as well as customizable options.

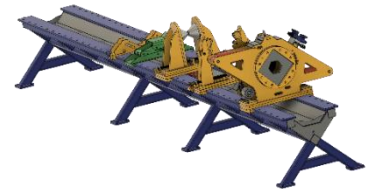

NBW-190

Chain Vise

QTY: 2

- The heavy-duty chain vise, which is mounted to the work bench, is used to secure and to work on cylinders.
- Once secured, the cylinder will not move as it is disassembled or as its gland is removed.
- The vise is mounted to the bench and is easy to set up for each job.
- The chain vise secures cylinders up to 30”.



NBW-210

Push/Pull Plate

QTY: 1

- This attachment, in conjunction with a push-pull cylinder, is used to pull or push the rod assembly in or out of the cylinder.
- The plate is connected to the work bench and to the back eye of the push/pull cylinder.
- This plate is designed to accommodate a 3” back eye from the push/pull cylinder.



NBW-220

Push/Pull Cylinder

QTY: 1

- The push/pull cylinder is in conjunction with the push/pull plate.
- Cylinder size: 3.5” * 48”



Power Unit/Test unit

QTY: 1

**Standard Power unit:
Comes with table**

Pressure	2500 - 3000 PSI
Pump capacity	2 – 5 GPM
Hydraulic oil	HV32
Power	5 HP, 110 – 220 V, AC line
Tank capacity	20 Gallons

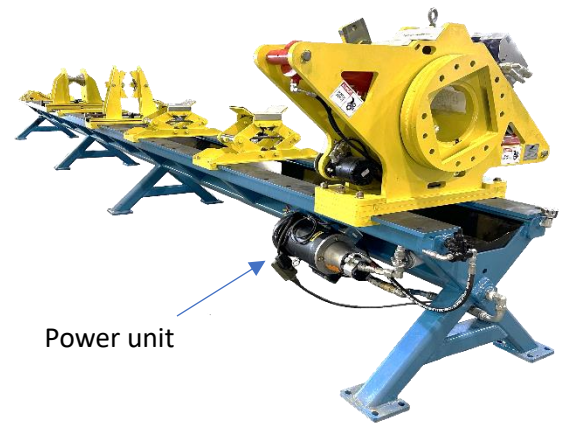

**Large Testing Power unit:
THP**

Pressure	5000 PSI (10000 upon request)
Pump capacity	8 GPM
Hydraulic oil	HV32
Power	20 HP, Voltage customizable, AC line
Tank capacity	100 Gallons

